

# PW4M

## SINGLE POINT TYPE LOAD CELL

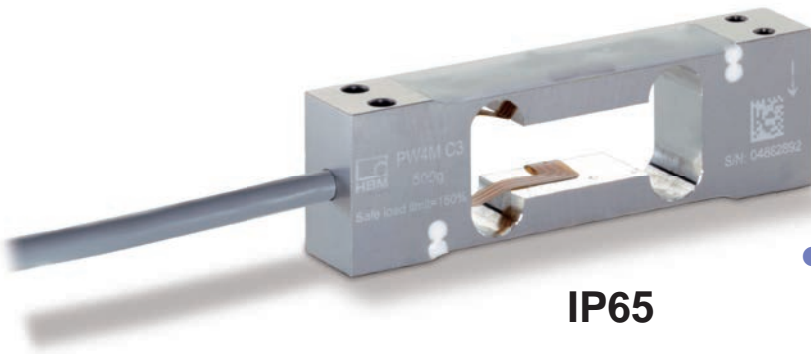

IP65

● Application example

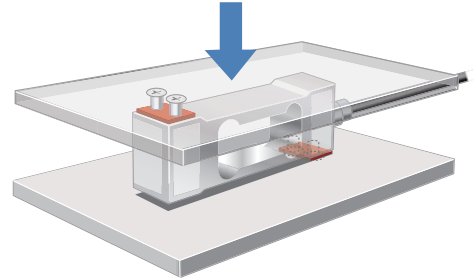

Specifications

Model	PW4M-300G, PW4M-500G	PW4M-1KG, PW4M-2KG, PW4M-3KG
Rated capacity	300 g, 500 g	1 kg, 2 kg, 3 kg
Rated output	1±0.1 mV/V	2±0.2 mV/V
Safe overload	150% R.C.	
Maximum safe side overload	200% R.C.	
Zero balance	0 ± 0.1 mV/V	
Non-linearity	0.0150% R.O. typ.	
Hysteresis	0.0150% R.O. typ.	
Compensated temperature range	-10 to +40°C	
Safe temperature range	-10 to +50°C	
Temperature effect on zero	0.0233% R.O./10°C (300 g), 0.0280% R.O./10°C (500 g) 0.020% R.O./10°C (1/2/3 kg)	
Temperature effect on span	0.0175% R.O./10°C (+20 to +40°C), 0.0117% R.O./10°C (-10 to +20°C)	
Input resistance	380±38	
Output resistance	380±38	
Recommended excitation voltage	1 to 15 V	
Insulation resistance	2000 M or more	
Degrees of protection	IP65	
Cable	φ 4 4-conductor shield cable 0.4 m, Cable end: 5 wires	
Load cell material	Aluminum	

● Wiring diagram

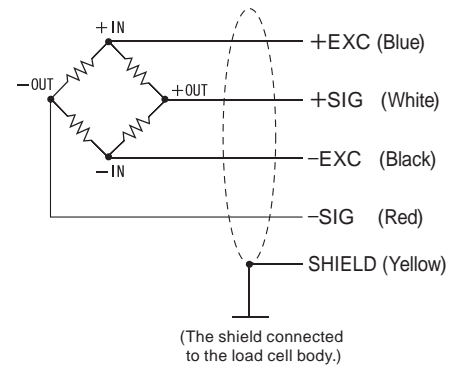

External dimension

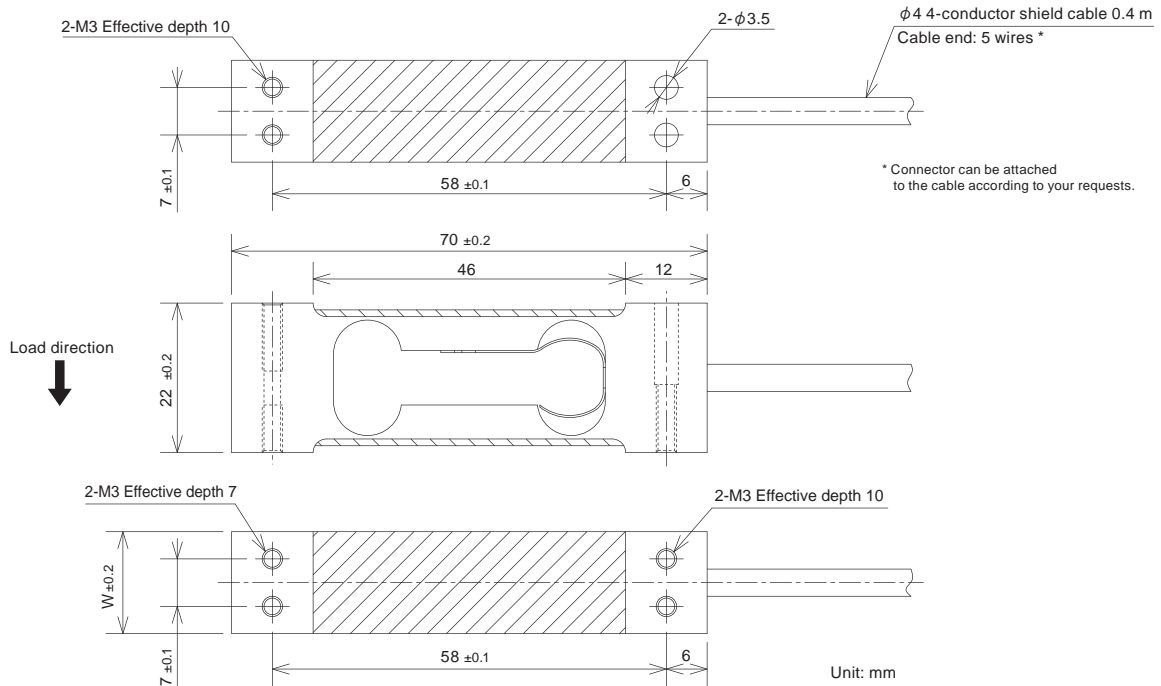

Model	Deflection at rated	Natural frequency	Maximum off center distance	Maximum platform size	Weight	W
PW4M-300G	0.5 mm or less	225 Hz	100 mm	200x200 mm	0.05 kg	12
PW4M-500G		294 Hz				
PW4M-1KG		294 Hz				
PW4M-2KG		397 Hz				
PW4M-3KG		493 Hz				