

# UBFH CENTER-HOLE TYPE LOAD CELL



Easy to use low profile center hole load cell. Suitable for measurement of axial bolt force, press-fitting, and caulking.



Flexible cable

## Specifications

Model	UBFH-1KN, UBFH-2KN	UBFH-5KN	UBFH-10KN, UBFH-20KN
Rated capacity	1 kN, 2 kN	5 kN	10 kN, 20 kN
Rated output	Approx. 1 mV/V		
Safe overload	150% R.C.		
Zero balance	±10% R.O.		
Non-linearity	0.1% or less R.O.	0.2% or less R.O.	0.5% or less R.O.
Hysteresis	0.2% or less R.O.		0.5% or less R.O.
Repeatability	0.1% or less R.O.		0.3% or less R.O.
Compensated temperature range	-10 to +60°C		
Safe temperature range	-10 to +70°C		
Temperature effect on zero	0.3% R.O./10°C or below		
Temperature effect on span	0.2% R.O./10°C or below		
Input resistance	Approx. 1000 Ω		
Output resistance	Approx. 1000 Ω		
Recommended excitation voltage	10 V		
Maximum excitation voltage	15 V		
Insulation resistance (DC 50 V)	1000 MΩ or more		
Cable	φ3.8 4-conductor flexible cable 3 m Cable end: 5 wires		
Load cell material	Stainless steel		
RoHS directives	2011/65/EU (EU)2015/863		

## Application example

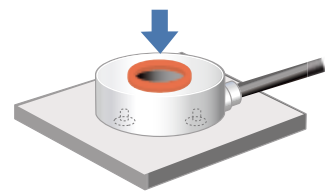

## Wiring diagram

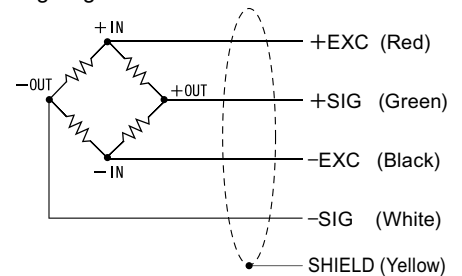

## External dimension

### UBFH-1KN/2KN/5KN

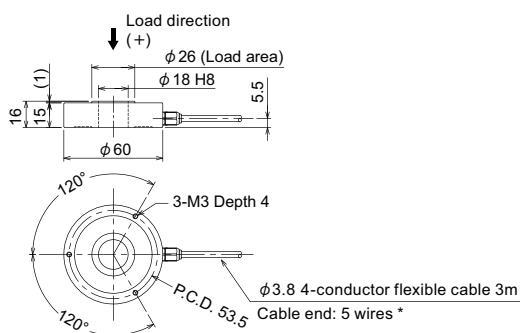

### UBFH-10KN/20KN

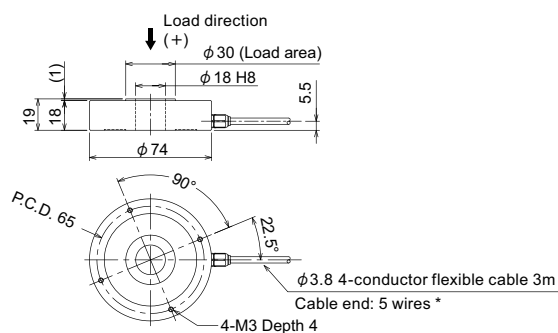

## Optional accessories

A load button which helps measuring compression force.

### UBFH-LB (1 kN, 2 kN, 5 kN)

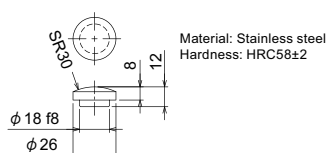

### UBFH-LB2 (10 kN, 20 kN)

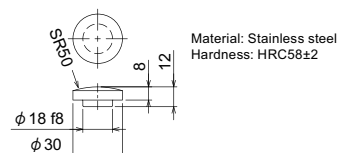

\* Connector can be attached to the cable according to your requests. Refer to 84 pages for details.

Model	Deflection at rated	Natural frequency	Weight
UBFH-1KN	0.030 mm	5.0 kHz	280 g
UBFH-2KN		7.3 kHz	
UBFH-5KN		11 kHz	
UBFH-10KN	0.035 mm	9.7 kHz	470 g
UBFH-20KN		13 kHz	

Unit: mm