

PW4M

SINGLE POINT TYPE LOAD CELL

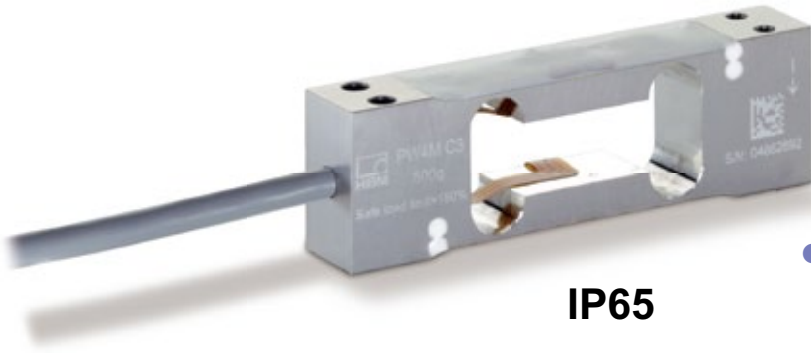

IP65

● Application example

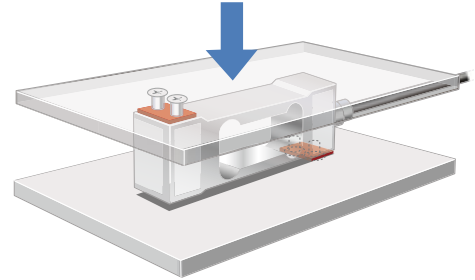

Specifications

| Model | PW4M-300G, PW4M-500G | PW4M-1KG, PW4M-2KG, PW4M-3KG |
|--------------------------------|---|------------------------------|
| Rated capacity | 300 g, 500 g | 1 kg, 2 kg, 3 kg |
| Rated output | 1±0.1 mV/V | 2±0.2 mV/V |
| Safe overload | 150% R.C. | |
| Maximum safe side overload | 200% R.C. | |
| Zero balance | 0±0.1 mV/V | |
| Non-linearity | 0.0150% R.O. typ. | |
| Hysteresis | 0.0150% R.O. typ. | |
| Compensated temperature range | -10 to +40°C | |
| Safe temperature range | -10 to +50°C | |
| Temperature effect on zero | 0.0233% R.O./10°C (300 g), 0.0280% R.O./10°C (500 g) 0.020% R.O./10°C (1/2/3 kg) | |
| Temperature effect on span | 0.0175% R.O./10°C (+20 to +40°C), 0.0117% R.O./10°C (-10 to +20°C) | |
| Input resistance | 380±38 Ω | |
| Output resistance | 380±38 Ω | |
| Recommended excitation voltage | 1 to 15 V | |
| Insulation resistance | 2000 MΩ or more | |
| Degrees of protection | IP65 | |
| Cable | φ4 4-conductor shield cable 0.4 m, Cable end: 5 wires | |
| Load cell material | Aluminum | |

● Wiring diagram

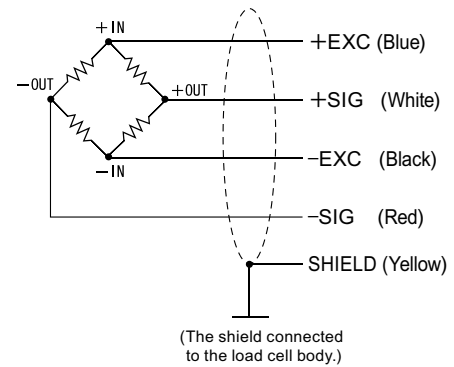

External dimension

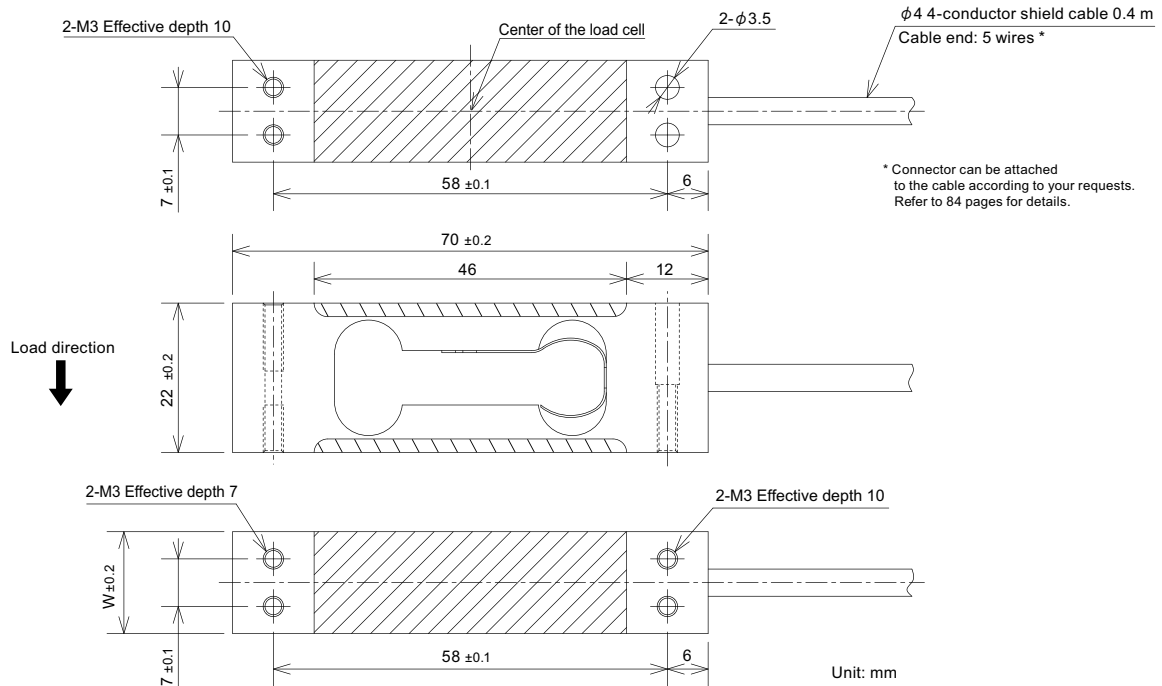

| Model | Deflection at rated | Natural frequency | Maximum off center distance | Maximum platform size | Weight | W |
|-----------|---------------------|-------------------|-----------------------------|-----------------------|---------|----|
| PW4M-300G | 0.5 mm or less | 225 Hz | 100 mm | 200×200 mm | 0.05 kg | 12 |
| PW4M-500G | | 294 Hz | | | | |
| PW4M-1KG | | 294 Hz | | | | |
| PW4M-2KG | | 397 Hz | | | | |
| PW4M-3KG | | 493 Hz | | | | |